

### Block 6: Sunflower - Carrie Nelson

Use (1) light, (1) dark, and (1) medium fabric. Fabrics are listed in order of use.

- A - (12) squares, 1 1/2" x 1 1/2" (LIGHT)
- B - (4) squares, 1 1/2" x 1 1/2" (DARK)
- C - (4) rectangles, 1 1/2" x 2 1/2" (LIGHT)
- D - (8) rectangles, 1 1/2" x 2 1/2" (MEDIUM)
- E - (1) square, 2 3/4" x 2 3/4" for applique (LIGHT)
- F - (1) square, 2 1/2" x 2 1/2" (MEDIUM)

- 4. Lay out Unit #1a's, Unit #1b's, Unit #2's, and Unit #3, as shown. Sew into rows; press each row in opposite direction. Sew rows together (press open) to create the Sunflower block measuring 6 1/2" square.

#### Assembly

1. Sew (1) A square to (1) B square; press toward B. Sew (1) C rectangle to top of A/B unit; press toward A/B. Make (2) Unit #1a and (2) Unit #1b.

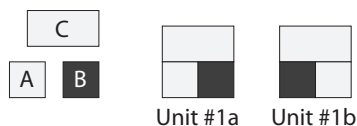

2. Layer (1) A square on the end of (1) D rectangle; pin in place. Sew diagonally across A square, as shown; trim corner to a 1/4" seam allowance and press toward D. Make (2) A/D units. Sew A/D units together; press seam to one side. Make (4) Unit #2.

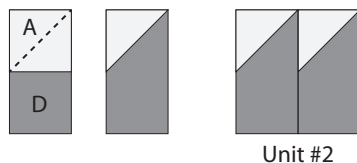

3. Using circle template (at right) with E square and applique method-of-choice, applique E circle (see page 2) to F square. Make (1) Unit #3.

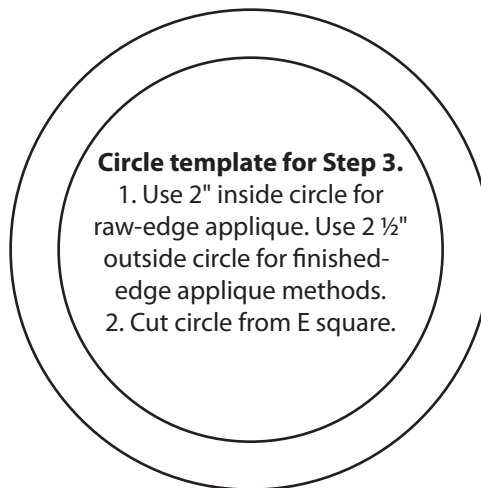
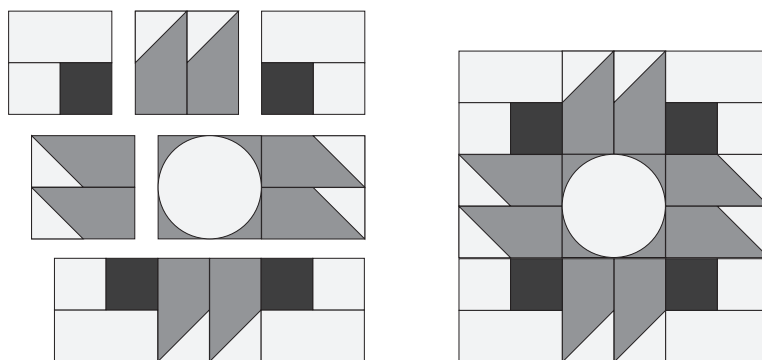
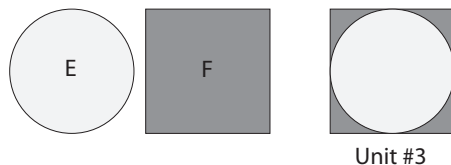

#### Circle template for Step 3.

1. Use 2" inside circle for raw-edge applique. Use 2 1/2" outside circle for finished-edge applique methods.
2. Cut circle from E square.

### *moda* 2017 Block Heads Participating Designers

Lynne Hagmeier of Kansas Troubles

<http://kansastroublesquilters-lynn.blogspot.com/>

Jan Patek

<http://www.janpatekquilts.com/>

Betsy Chutchian

<http://betsysbestquiltsandmore.blogspot.com/>

Lisa Bongean

<http://lisabongean.com/>

Jo Morton

[http://jomortonquilts.com/jos\\_journal/](http://jomortonquilts.com/jos_journal/)

Carrie Nelson

<http://blog.modafabrics.com>

Share your blocks on social media #modablockheads